

PUBLIC NOTICE

The South Dakota Board on Geographic Names (SDBGN) seeks public comment on a proposed new name for a geographic feature:

RECEIVED

Harney Peak in Pennington County

MAR 18 2015

One name has been proposed: Black Elk Peak. The Board is seeking public comment regarding the recommended name change or if there are any additional proposed new names for the feature.

RAPID CITY COMMUNITY PLANNING
& DEVELOPMENT SERVICES

The above feature is currently named Harney Peak and the SDBGN requests public input on a name for the geographic feature. Based on the U.S. Board on Geographic Names guidelines, the following principles apply:

- Names descriptive of topographic form, suggested by local history, folklore, or incident, or by associated natural life or other phenomena are preferred including American Indian or other ethnic names appropriate to the area.
- A proposed name should not duplicate another name in the state or nearby in an adjoining state.
- If a personal name is proposed, it must be determined in the public interest to honor the person or family for historical or commemorative reasons.
- If a personal name is proposed, the person or persons must be deceased for at least five years.
- If a personal name is proposed, it should just include the surname.

This process is intended to seek public comment on proposed names for unnamed features or new names of existing features. No name should imply discrimination or be derogatory to a particular racial or ethnic group, gender, or religious group. This also includes names considered obscene in a present-day cultural context.

The board is taking written comments until May 1, 2015. SDBGN is also holding meetings across the state for the purpose of taking public comment on the name for the feature. The meetings will be held as follows:

- | | | |
|----------------------------|---|-------------------------|
| April 28, 2015 (Tuesday) | Martin, SD
Library/Community Room
101 Main Street | 5:00pm – 7:00pm (MDT) |
| April 29, 2015 (Wednesday) | Custer, SD
Custer County Annex/Library
447 Crook Street, Suite #1 | 10:00am – 12:00pm (MDT) |

April 29, 2015 (Wednesday)	Rapid City, SD Adoba Eco Hotel – Ballroom 445 Mt. Rushmore Road	5:00pm – 7:00pm (MDT)
May 5, 2015 (Tuesday)	Flandreau, SD Royal River Hotel – Royal Room 607 S. Veterans Street	5:00pm – 7:00pm (CDT)
May 6, 2015 (Wednesday)	Pierre, SD SD Cultural Heritage Center 800 Governors Drive	5:00pm – 7:00pm (CDT)

Please note the Custer meeting is starting at 10:00am (MDT). All other meetings start at 5:00pm local time. The meetings are an open forum for public comment that will allow individuals to come any time within the time period stated above. The board will be available to the public for a minimum of two hours in each location. SDBGN will extend its meeting in any location to accommodate individuals who wish to give public comment.

If recommending a new name for the feature, the basic information requested is a recommended name, reason/justification for the name, and the origin/meaning of the name. Or complete the second section of the public comment form found on the website at: www.sdbgn.sd.gov.

If the recommended name is adopted by the SDBGN, additional information may be needed to support the recommendation to the U.S. Board on Geographic Names. It is important if submitting written comments to give us much detail as possible. The U.S. Board on Geographic Names has the ultimate authority to approve names for geographic features.

Written comments should be submitted no later than May 1, 2015. Submit comments to:

SD Board on Geographic Names
Dept. of Tribal Relations
302 East Dakota
Pierre, SD 57501
FAX: 605-773-6592
Email: David.Reiss@state.sd.us

Or access Public Comment Form: <http://www.sdbgn.sd.gov/>

Written comments will also be accepted at any of the public meetings.



PUBLIC COMMENT FORM

The South Dakota Board on Geographic Names (SDBGN) is a state commission created in 2009 by SDCL Chapter 1-19C to recommend revision of offensive names for geographic places. The SDBGN has adopted a Public Involvement Process which seeks public comment on the existing historic name and offering recommendations and justification for the new name as well as names for unnamed geographic features. The SDBGN follows the United States Board on Geographic Names' principles, policies, and procedures. For further information visit: <http://geonames.usgs.gov/domestic/policies.htm>

Current Name: Harney Peak

Proposed Name(s): Black Elk Peak

Location/Identification: Pennington County: Located in the Black Hills National Forest

The above feature is currently named Harney Peak and the SDBGN is soliciting public input on the current name and the proposed new name for the geographic feature. One name has been proposed. Please complete the section if supportive of the current name or the proposed new name.

Support naming the Feature: Black Elk Peak _____ Harney Peak _____

Reason/Justification of support to name the feature Harney Peak or Black Elk Peak:

Please attach any supporting documentation such as resolutions from governing boards or organizations; newspaper articles; petitions or historical references.

To propose a new name for the feature, please complete the section below:

Recommended Name:

Reason/Justification for Name:

Origin/Meaning of Name:

Please attach any supporting documentation such as resolutions from governing boards or organizations; newspaper articles; petitions or historical references.

Submitted by:

Name:
Title (if representing organization or public entity):
Organization or Public Entity (if applicable):
Mailing Address:
Telephone:
Email Address:

If the recommended name is adopted by the SDBGN, additional information may be needed to support the recommendation to the U.S. Board on Geographic Names.

Comments should be submitted no later than May 1, 2015. Submit comments to:

SD Board on Geographic Names
Dept. of Tribal Relations
302 East Dakota
Pierre, SD 57501

Email: David.Reiss@state.sd.us
FAX: 605-773-6592

Or access Public Comment Form: <http://www.sdbgn.sd.gov/>

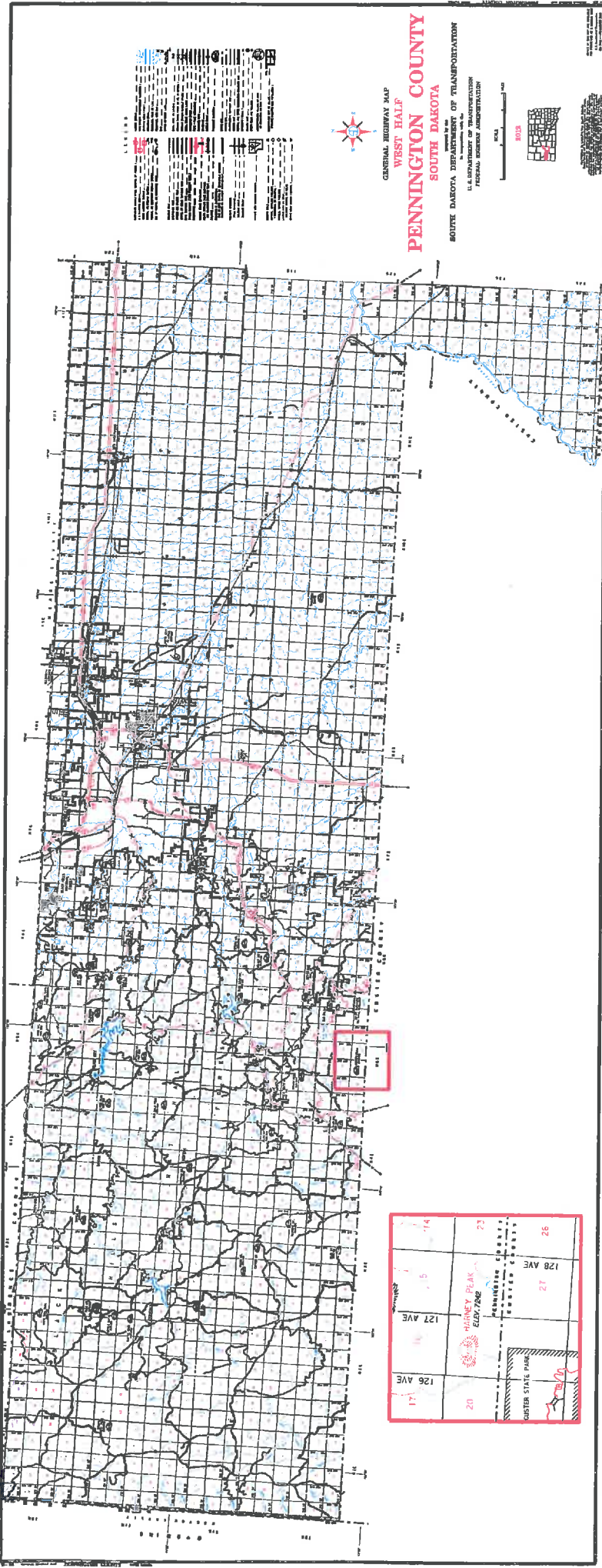

LEGEND

	Interstate Highway
	State Highway
	County Road
	Private Road
	Waterway
	Lake
	Swamp
	Marsh
	Pasture
	Cultivated Land
	Forest Land
	Open Land
	Town Boundary
	Township Boundary
	Section Boundary
	Section Number
	Township Number
	Range Number
	Meridian
	Township Name
	Range Name
	Section Name
	Township Name
	Range Name
	Section Name



GENERAL HIGHWAY MAP
WEST HALF
PENNINGTON COUNTY
SOUTH DAKOTA
 ROUTE DAKOTA DEPARTMENT OF TRANSPORTATION
 FEDERAL BUREAU OF INVESTIGATION

